

Rev.	Designer	Date
B	BAL	06.12.2022

Brukerveiledning for Hydraulisk kantving 256THS Big Art.nr 22294

Beskrivelse

Hydraulisk kantving 256THS Big art 22294 er utstyr designet for bruk på Tokvam 256 THS Big. Det er egnet for bæremaskiner beskrevet i hovedproduktets brukerveiledning.

CE merking garanti

Modifisering/ endringer og ombygginger utover hva som er beskrevet i denne brukermanualen medfører at CE merkingen bortfaller. Det samme gjelder opprinnelig produsent ansvar og garanti.

Tokvam AS står ikke ansvarlig for eventuelle skader som oppstår som konsekvens av at utstyret brukes utenom tiltenkte bruksområde beskrevet i brukerveiledningen.

Tokvam driver kontinuerlig produktutvikling, og forbeholder oss retten til å endre data og spesifikasjoner på nye maskiner uten forutgående varsel.

!Sikkerhet

-Det er førerens ansvar å sørge for at redskapen ikke medfører en sikkerhetsrisiko for seg selv eller andre.

-Vær oppmerksom på bredde, høyde og vekt ved montering av tilleggsutstyr, sikt og kjøreegenskaper kan endres!

- Vær oppmerksom på klemfare når kantvingen beveges.

Vedlikehold

- Etersyn av hydrauliske slanger
- Trekk til alle skruer og muttre etter 10 timer
- Smør fettnippler på sylinder samtidig med smøring av snøfreseren (hver 40 time).

Vekt

- ca. 100 kg

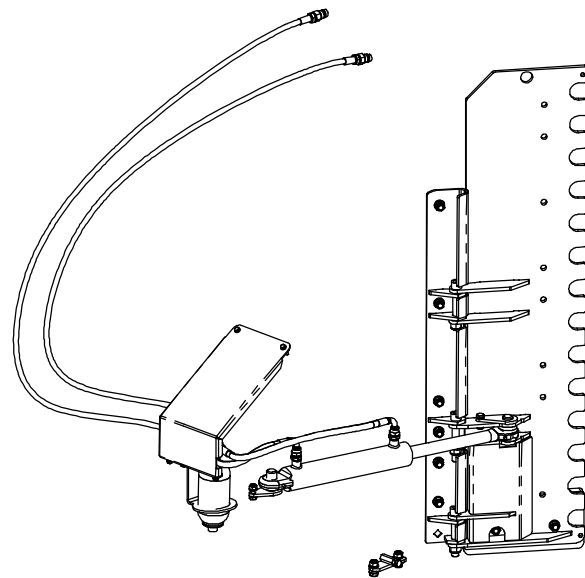

Users manual for Hydraulic extension wing 256THS Big Art.no 22294

Description

Hydraulic extension wing 256THS Big art 22294 equipment is design for use on Tokvam 256 THS Big. It is designated for carrier vehicles described in primary products user's manual.

CE certified warranty

Any modification, change or conversion of this product will discontinue warranty. This also applies to Tokvam's responsibility and warranty.

Tokvam AS cannot be held responsible for any harm that may occur from use that is not described in this user's manual.

Tokvam AS is continuously improving our products, and we reserve the rights to make changes to any specifications of new products without further notice.

!Safety

-It is the driver's responsibility to ensure that the machine is not used or handled incorrectly.

-Pay attention to width, height and weight when additional equipment is attached, this can change handling and visibility!

- Pay attention when moving side wing, risk of crushing injuries.

Maintainance

- Tighten all nuts and bolts after 10 hours use.
- Lubricate grease nipples on cylinder at the same time as lubricating the snow blower (every 40 hour).
- Check hydraulic hoses.

Weight:

- ca. 100 kg

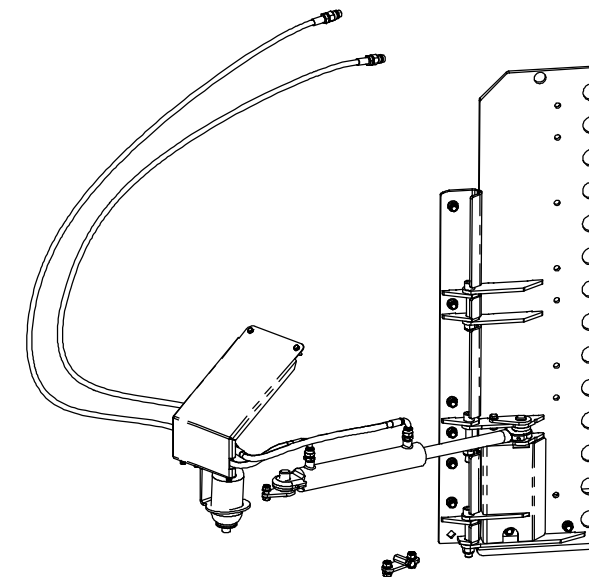

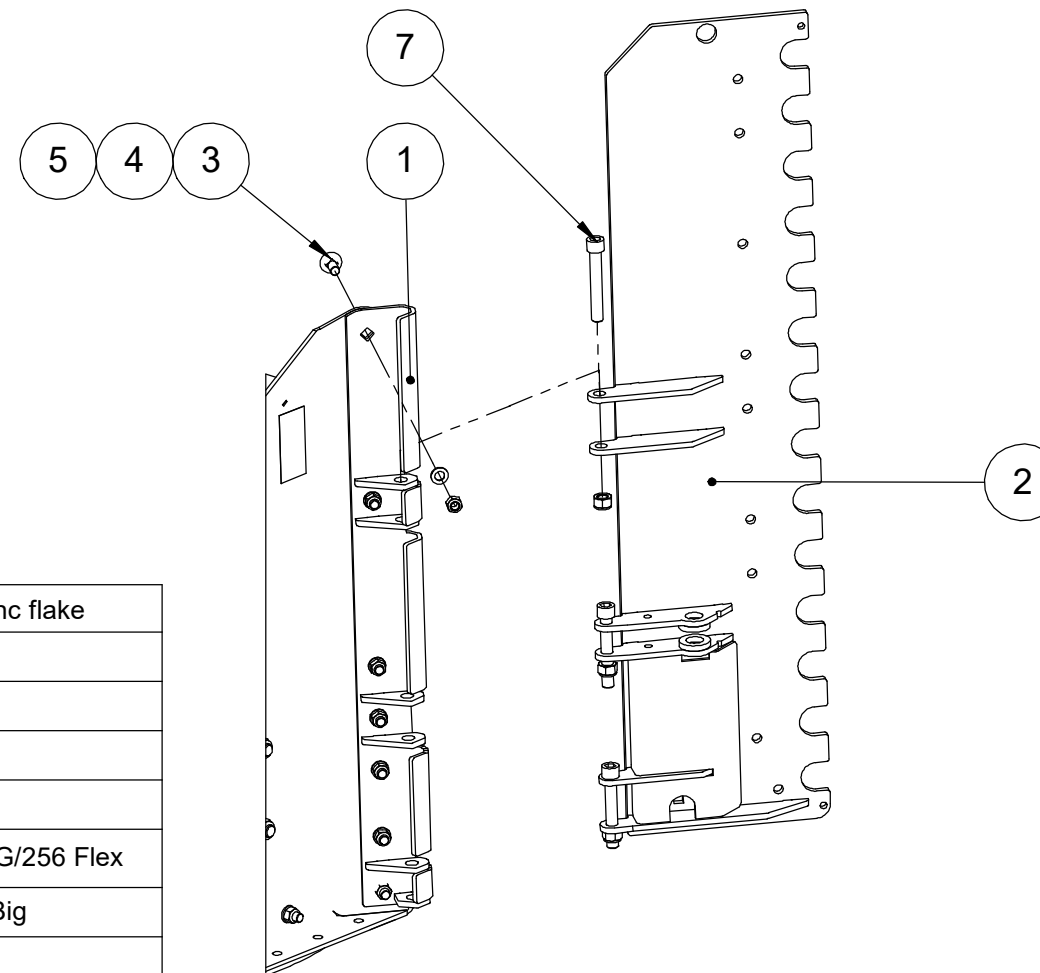
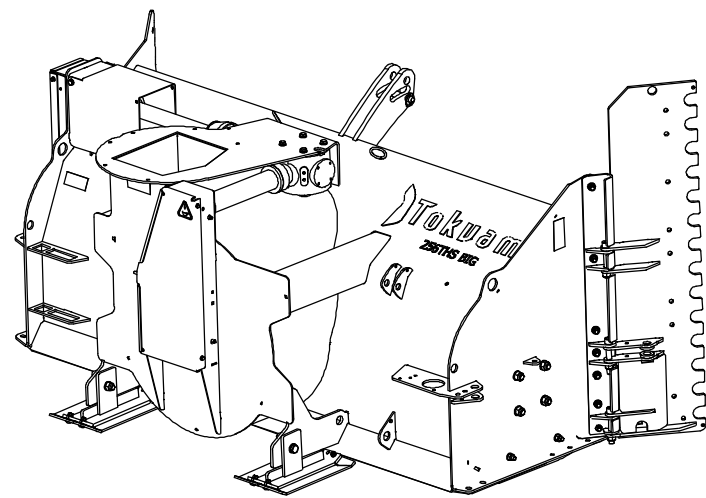
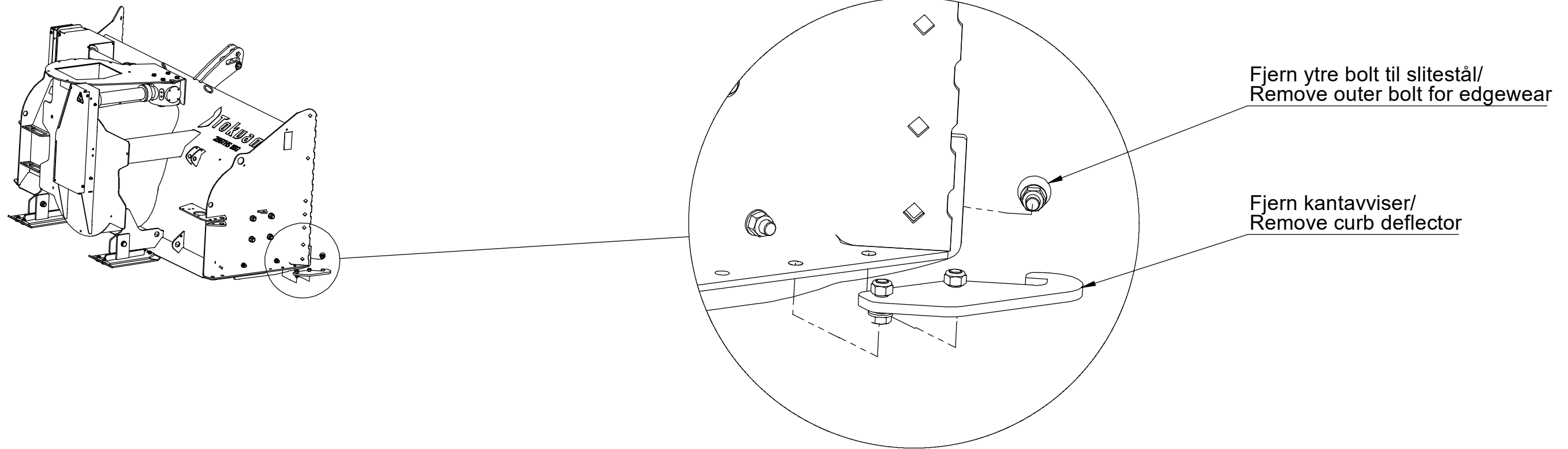

7	3	22311	Innv.6-kantskrue M20x130 12.9 Zinc flake	Socket screw M20x130 12.9 Zinc flake
6	3	10122	Låsemutter M20	Lock nut M20
5	6	10043	Låsemutter M16	Lock nut M16
4	6	10364	Underlagsskiver M16	Washer M16
3	6	21841	Låseskrue M16x40	Carriage screw M16x40
2	1	17326	Hyd.kantving blad 240/BIG/256 Flex	Hydr. extension wing blade 240/BIG/256 Flex
1	1	22316	Kantving hengsle 256 Big	Extension wing hinge 256 Big
Pos.	Qty.	Art.no.	Description	EngDescription

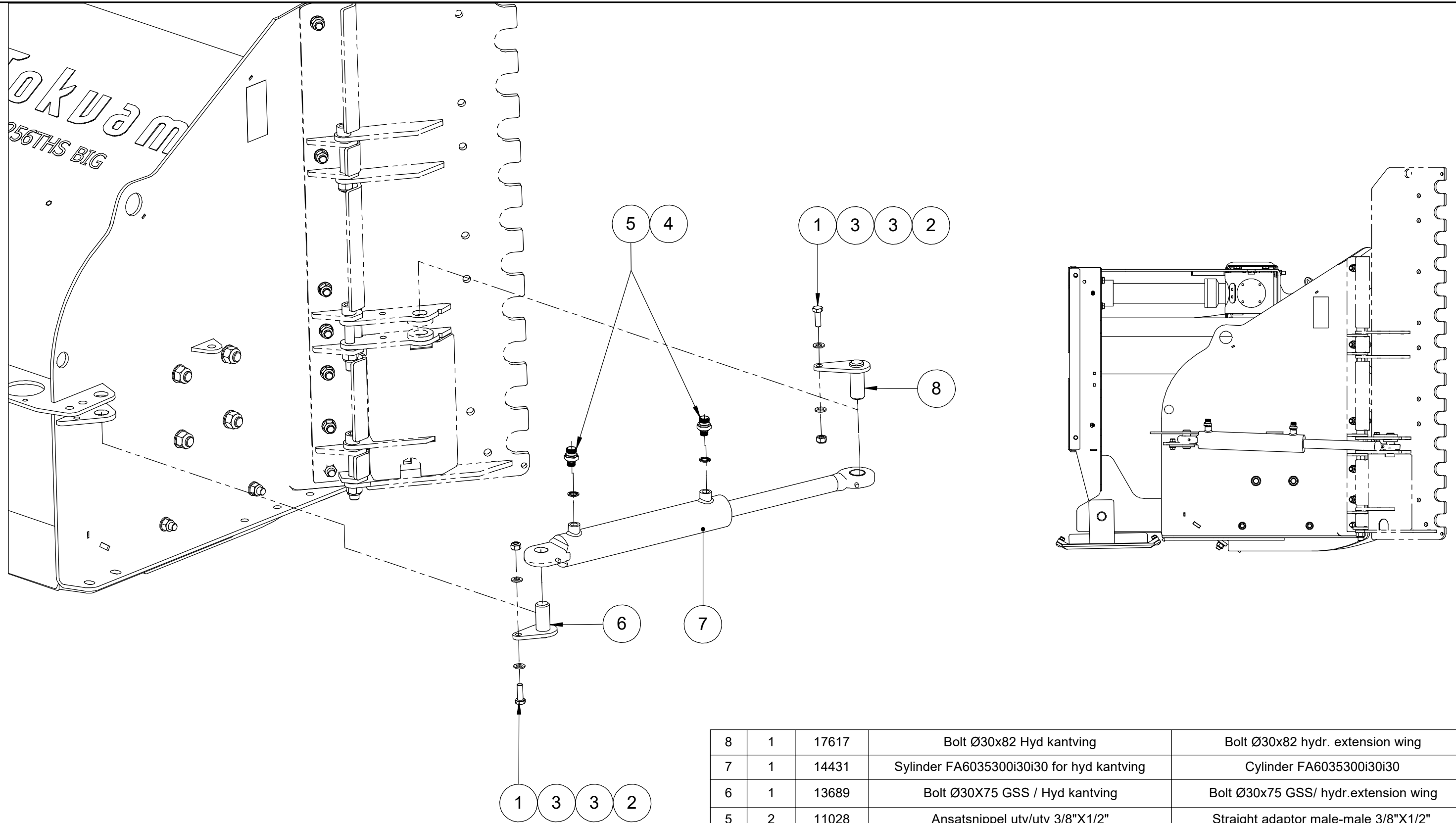

8	1	17617	Bolt Ø30x82 Hyd kantving	Bolt Ø30x82 hydr. extension wing
7	1	14431	Sylinder FA6035300i30i30 for hyd kantving	Cylinder FA6035300i30i30
6	1	13689	Bolt Ø30X75 GSS / Hyd kantving	Bolt Ø30x75 GSS/ hydr.extension wing
5	2	11028	Ansatsnippel utv/utv 3/8"X1/2"	Straight adaptor male-male 3/8"X1/2"
4	2	10275	Dowtypakning 3/8"	Dowty gasket 3/8"
3	4	10133	Underlagsskiver M12	Washer M12
2	2	10032	Låsemutter M12	Lock nut M12
1	2	10031	Sekskantskrue M12x35 helgjenget	Hex screw M12x35 full threaded
Pos.	Qty.	Art.no.	Description	EngDescription

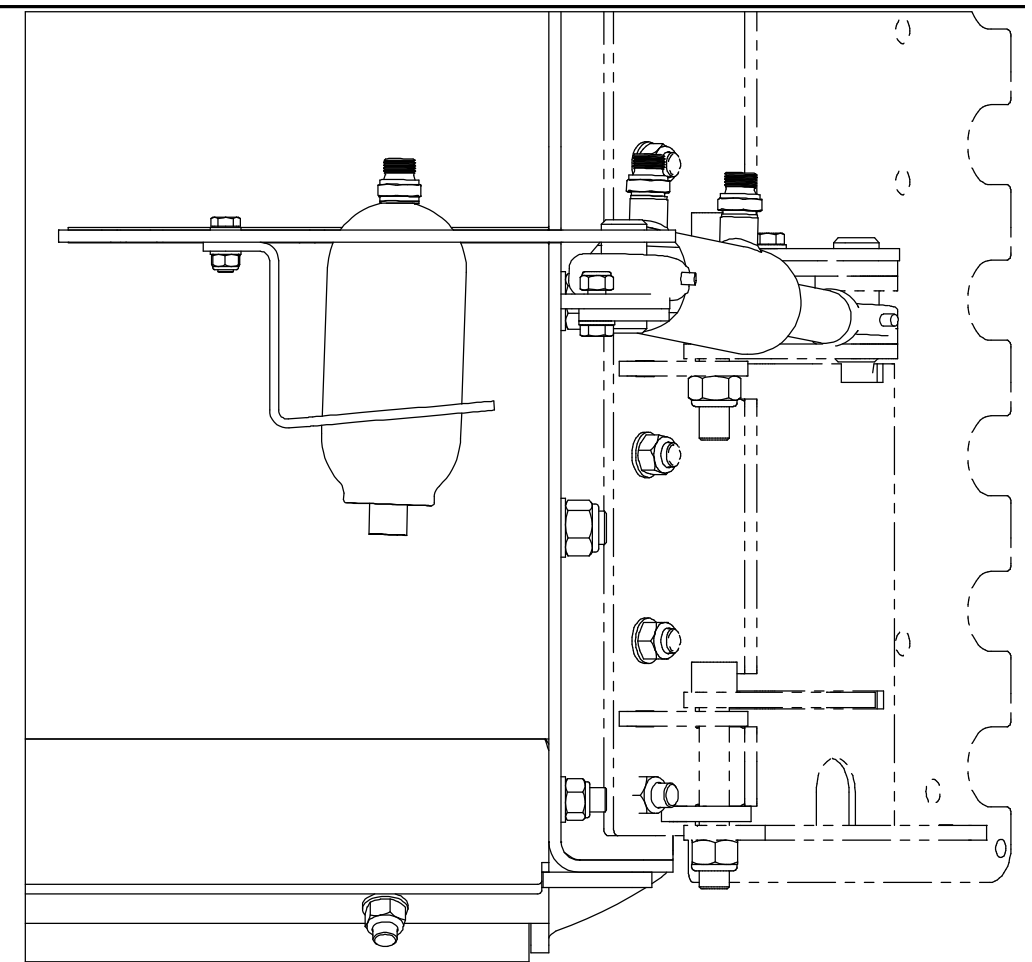
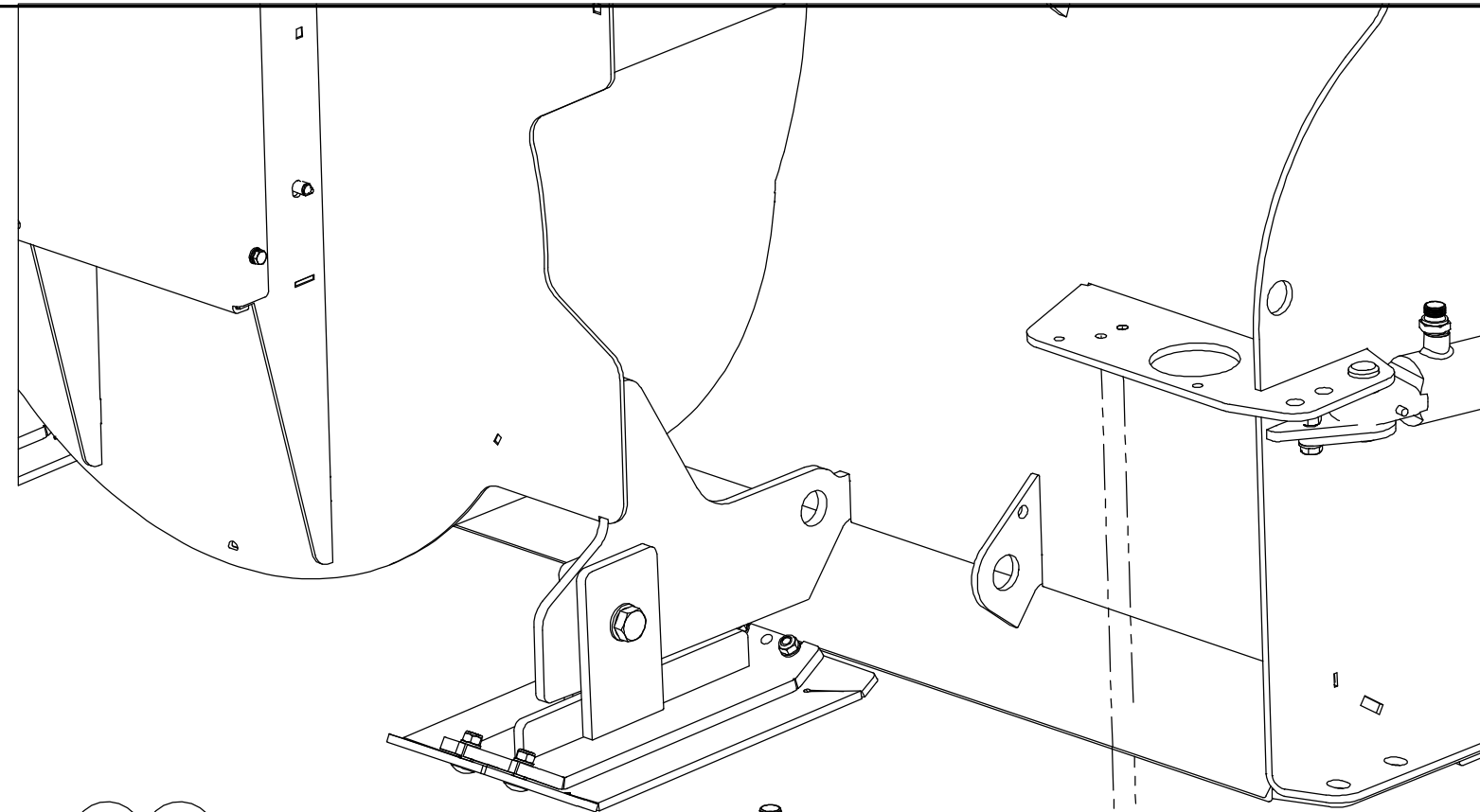

- 4 M18 mot akkumulator, nippelstr. vises på kork/
- 4 M18 to accumulator, size of nipple shown on cap

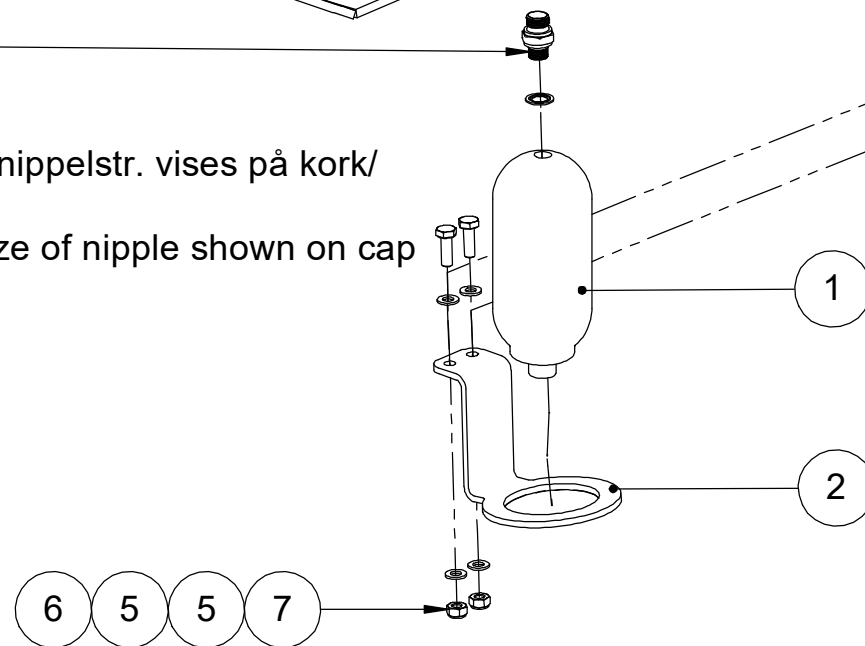

7	2	10077	Låsemutter M10	Lock nut M10
6	2	10142	Sekskantskrue M10x30 helgjenget	Hex screw M10x30 full threaded
5	4	11926	Underlagsskiver M10	Washer M10
4	1	16924	Ansatsnippel utv/utv M18x1,5x1/2"	Straight adaptor male-male M18x1,5x1/2"
3	1	16926	Dowtypakning M18	Sealing ring M18
2	1	14870	Akkumulatorfeste	Accumulator bracket
1	1	14864	Akkumulator 4:1 210Bar	Accumulator 45:1 210 Bar
Pos.	Qty.	Art.no.	Description	EngDescription

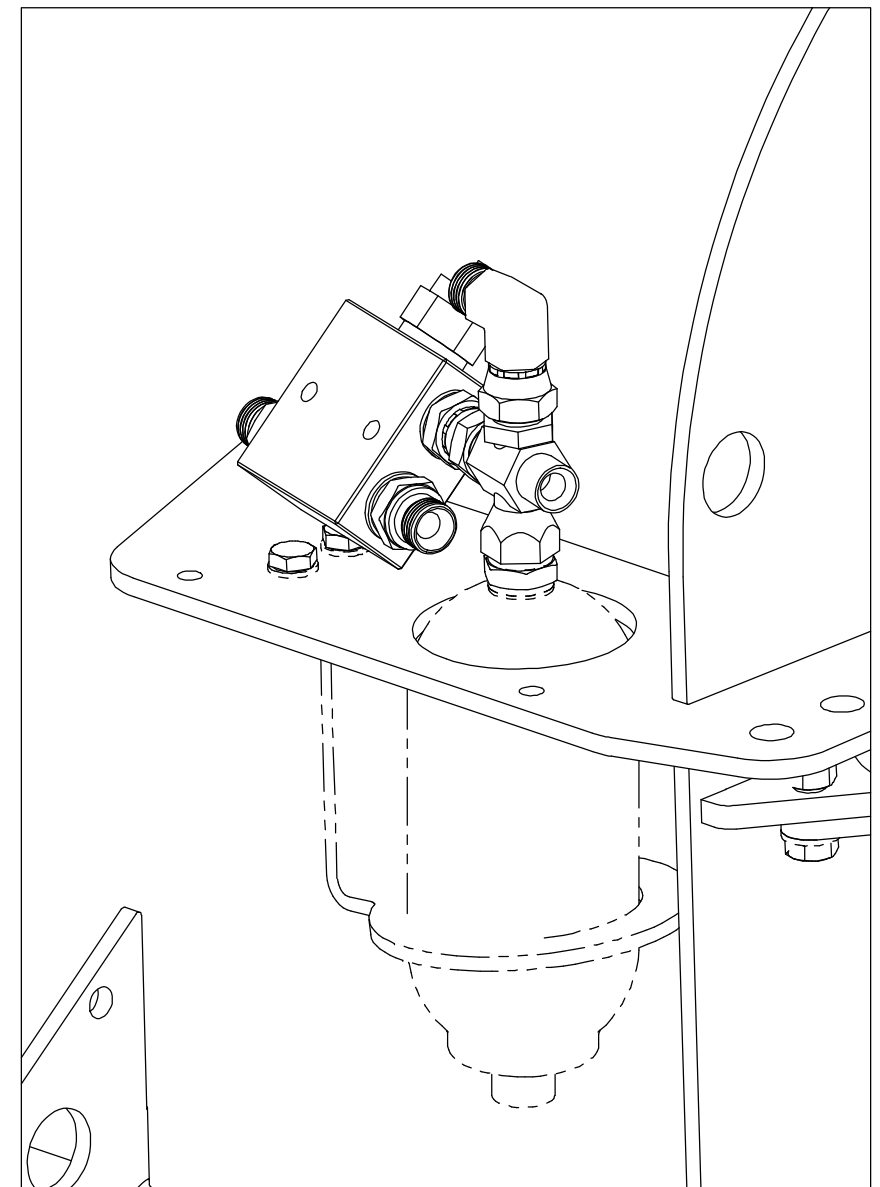
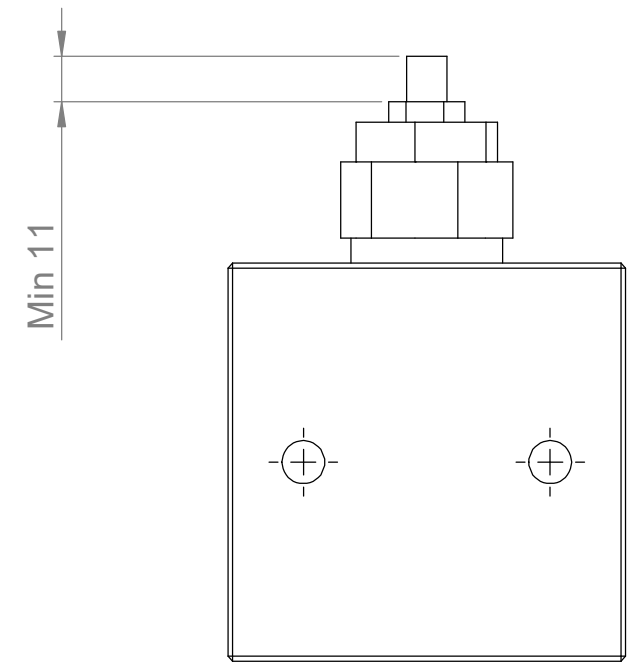
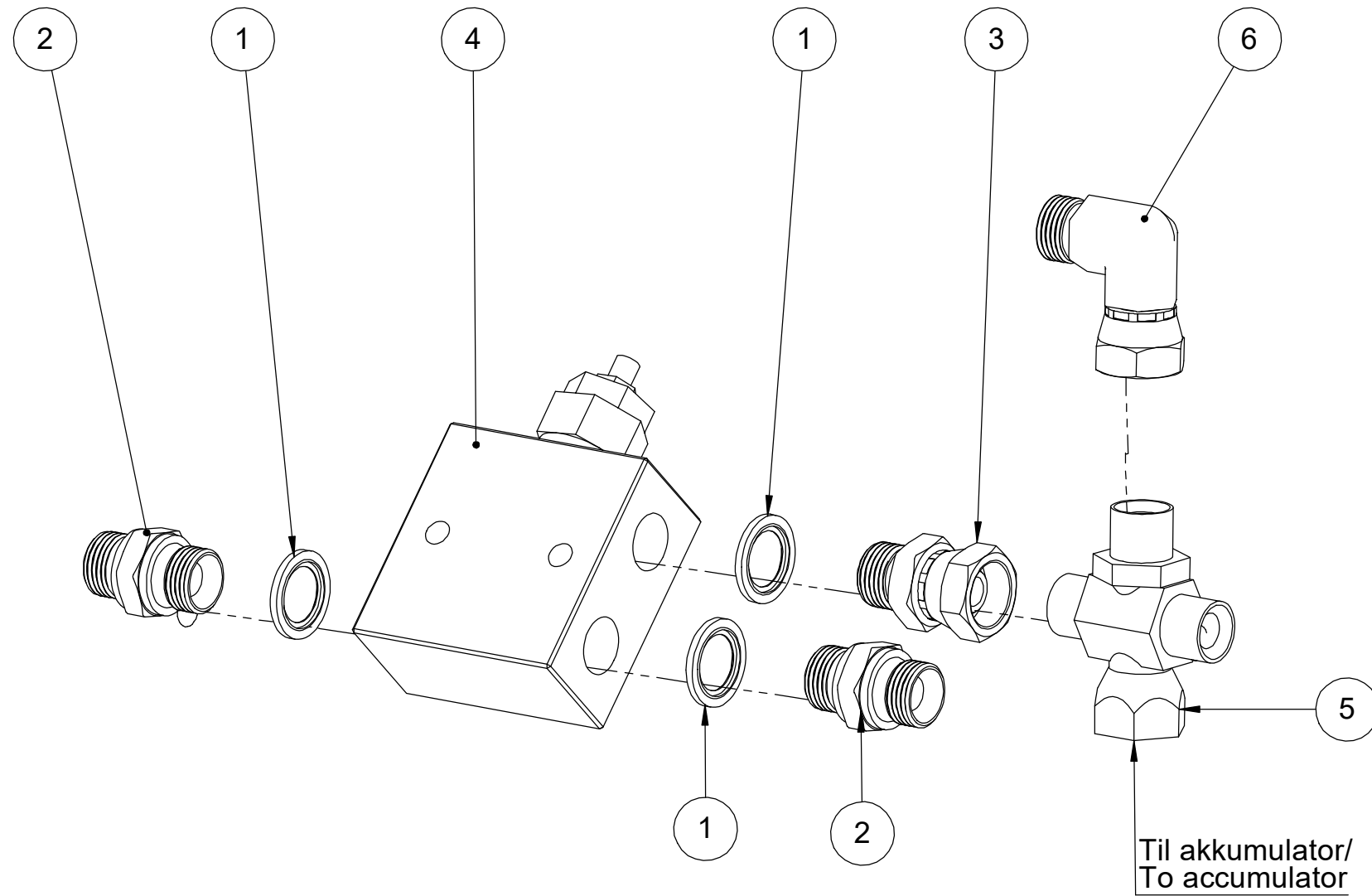

6	1	17258	90° 1/2" m/svivel smidd	90° 1/2" male/female
5	1	17256	Kryss 1/2" utv+1/2" utv+1/2" utv+1/2" svi	+ 1/2" male+1/2" male+1/2" male+1/2" female
4	1	14865	Overtrykksventilblokk 1/2" m/vlp65s-n,30-280b	Pressure relief valve 1/2" m/vlp65s-n,30-280b
3	1	12366	Ansatsnippel utv/svivel 1/2"X1/2"	Straight adaptor male/female 1/2"X1/2"
2	2	11093	Ansatsnippel bsp utv/utv 1/2"X1/2"	Straight adaptor bsp male-male 1/2"X1/2"
1	3	10594	Dowtypakning 1/2"	Sealing ring 1/2"
Pos.	Qty.	Art.no.	Description	EngDescription

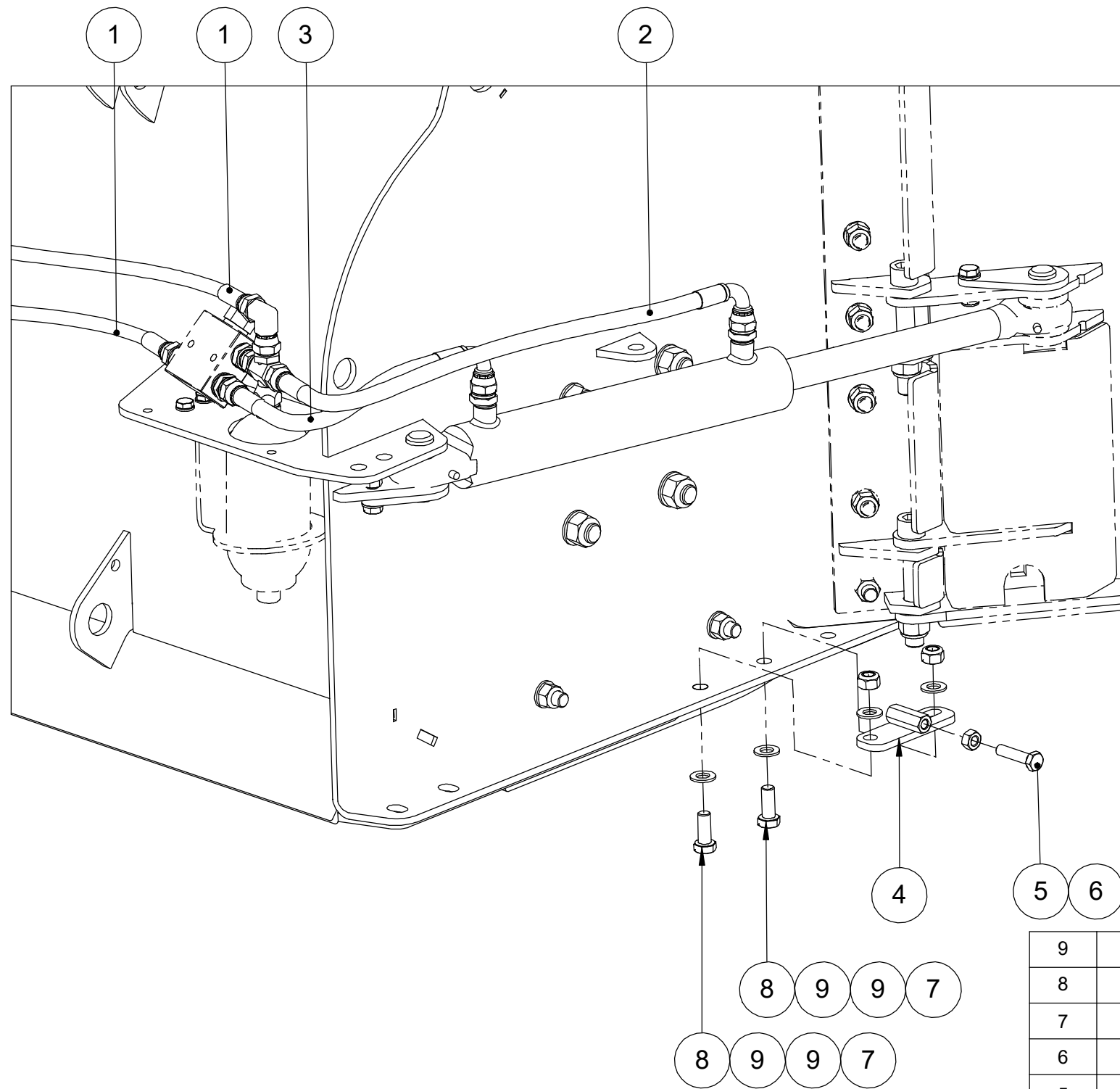

9	4	13126	Underlagsskiver M14	Washer M14
8	2	10290	Sekskantskrue M14x35 helgjenget	Hex screw M14x35 full threaded
7	2	10222	Låsemutter M14	Lock nut M14
6	1	10205	Mutter M12	Nut M12
5	1	10148	Sekskantskrue M12x50 helgjenget	Hex screw M12x50 full threaded
4	1	18024	Stopper hyd.kanving 256Flex/Big/240	Stop screw bracket hyd. extension wing
3	1	22439	1/2" slange 385 mm 1/2" rett sv-1/2"90°	1/2" hose 385 mm 1/2" straight -1/2"90°
2	1	22440	1/2" slange 690 mm 1/2" rett sv-1/2"90°	1/2" hose 690 mm 1/2" straight -1/2"90°
1	2	18390	3/8" Slange 3500mm 1/2"iso - rett sivel 1/2"	3/8" hose 3500mm 1/2"iso - straight 1/2"
Pos.	Qty.	Art.no.	Description	EngDescription

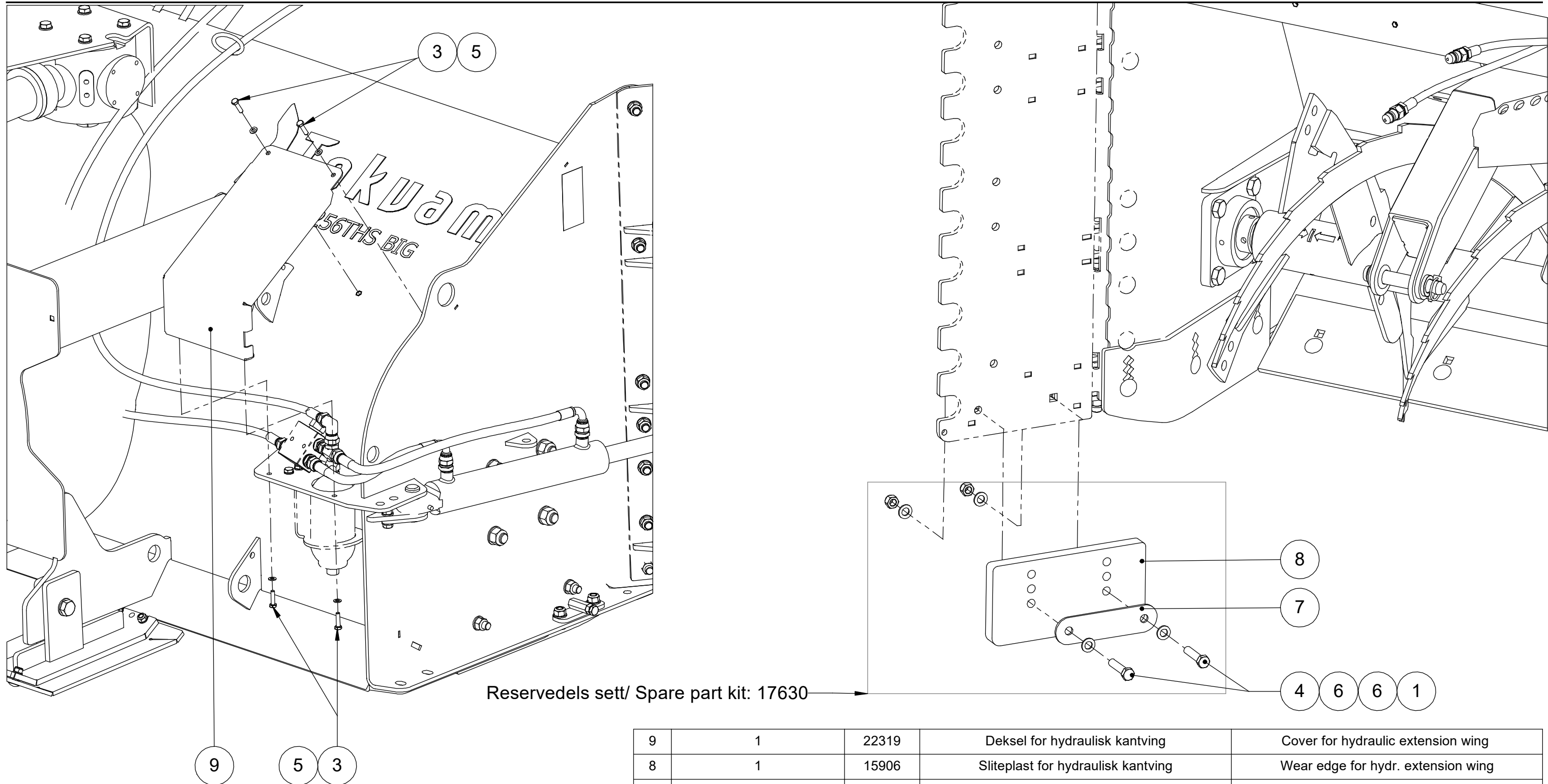

Reservedels sett/ Spare part kit: 17630

9	1	22319	Deksel for hydraulisk kantving	Cover for hydraulic extension wing
8	1	15906	Sliteplast for hydraulisk kantving	Wear edge for hydr. extension wing
7	1	15900	Skive for sliteplast	Washer for sliteplast
6	4	10364	Underlagsskiver M16	Washer M16
5	4	10293	Underlagsskiver M8	Washer M8
4	2	10147	Sekskantskrue M16x70 helgjennet	Hex screw M16x70 full threaded
3	4	10143	Sekskantskrue M8x30 helgjennet	Hex screw M8x30 full threaded
2	2	10133	Underlagsskiver M12	Washer M12
1	2	10043	Låsemutter M16	Lock nut M16
Pos.	Qty.	Art.no.	Description	EngDescription