



PALESTINE
SHELTER CLUSTER

Coordinating Humanitarian Shelter and Settlements

NATIONAL SHELTER CLUSTER MEETING

11 June 2025

INTRODUCTIONS

Jeroen Quanjer – National Coordinator

natco.palestine@sheltercluster.org

Maher Alabed – Sub-National Coordinator Gaza

coord2.palestine@sheltercluster.org

Fadi Shamisti – Sub-National Coordinator West Bank

coord1.palestine@sheltercluster.org

Iyad Abu Hammam – Gaza Coordinator

coord.gaza@sheltercluster.org

Mohammad Aklouk – IMO

im1.palestine@sheltercluster.org

David Dalgado – Technical Coordinator

techco.palestine@sheltercluster.org

Sneha Malani – Shelter Cluster Technical Advisor

Sneha.Malani@crs.org

Website - <https://sheltercluster.org/response/palestine>

Email Registration - [Shelter Cluster Mailing List Registry](#)

AGENDA

- General / National Update
- Gaza Updates
- WB Updates
- IM Update
 - Shelter cluster Palestine Dashboard
- Technical Update
 - IEC WG Share
- Discussion /Q&A
- AOB

CONTEXTUAL / NATIONAL UPDATE

- Gaza:
 - Shelter is at the bottom of the priority list for COGAT which is extremely concerning
 - Site Focal Point Self-Reporting: Most reported first-priority needs (SMC):
 - Food 65%; Shelter 17%; Household items: 12%
 - Data collection is difficult; generating top line figures as well; Advocacy and stepping up external communications.
 - Humanitarian aid operations face severe disruptions due to attacks, looting, and Israeli restrictions, making access and delivery extremely difficult.
- West Bank:
 - The situation in the Northern West Bank has significantly deteriorated in recent days, with marked escalation in military operations across several locations, ongoing restrictions on movement, widespread demolitions, and impacts on civilian infrastructure and residential areas.
- SAG meetings: Feedback on the SAG and Shelter response documents; Co-chairing notes for endorsement
- Donor briefings; HIP consultation session last week of July



PALESTINE
SHELTER CLUSTER

Coordinating Humanitarian Shelter and Settlements

GAZA UPDATE

Overview of the situation in Gaza

- **81% of Gaza is currently within "no-go" zones or under displacement orders (OCHA);** Ongoing evacuation orders and shelling continue to worsen the humanitarian situation
- Recent Displacement (15 May- 3 June): **202,675 people newly displaced**, 94,016 displaced in the 3 southern governorates, 108,659 displaced in the 2 northern governorates
 - Total displacement since 18 March: 640,273 individuals
- In Gaza City, the situation is **severely overcrowded**, with no vacant land remaining in the city, People are fleeing and displacing toward the western area (Al-Mina).
- Families are forced to shelter on sidewalks, streets, in every corner, and in any available open space. Residential buildings are severely overcrowded, and many families are sleeping in the open, without access to clean water, sanitation, or basic services.
- Some find refuge in government buildings, unfinished, abandoned, and even damaged buildings. They move rubble just to create space, and any semi-standing roof becomes a place to shelter in.
- According to a recent report by SMC depending on "Site Focal Point Self Reporting" assessment conducted during the period 22 to 29 May 2025, the shelter and NFI needs represent 29% of the priorities, and comes in the 2nd and 3rd top priorities after food (65%)

Overview of the situation in Gaza



- Cargo prioritization Meeting on 7th June:
- Currently, only food, health, nutrition supplies, and chlorine are authorized by COGAT. Shelter NFIs are not approved yet. Leadership advocacy remains essential to expand the approvals to all humanitarian sectors.
- Ashdod is currently the only operational corridor; discussions focused on this route. Other corridors may open during the week.
- There was general agreement in ICCG not to prioritize items that are not approved or ready for dispatch. and not to go with expectation .
- The Logistics Cluster raised serious concerns about looting, noting that the majority of recent trucks were looted or remain at high risk of looting .
- Despite this, there was an agreement to prioritize flour, even if looted, with the rationale that flooding the market with flour may help reduce the looting of other essential items in the future.
- **The Shelter Cluster highlighted it has a clear understanding of its pipeline and is ready to dispatch, noting specifically that 2,000 SOKs are currently stored in Ashdod and have been internally prioritized within the cluster.**

Current Shelter Partners' Response

- At the Shelter Cluster level, the response is very limited. There are no available stocks. Current activities are limited to a few individual cases and cash voucher assistance.
- **ACTED** in partnership with **HEKS** and **ACF** conducted a distribution for 45 households with framing kits and SOKs. Additional distribution in partnership with **PARC** is ongoing to replicate this intervention and support an additional 125 families in urgent need of shelter assistance.
- **PHC** completed assessment of 26 sites (19 in Khanyounis and 7 in Gaza) to identify the needs for shelter repairs and infrastructure maintenance, and will continue the assessment of additional 6 sites in West of Gaza.
- Following a successful pilot, **ACTED** has secured funding to distribute a total of 9,300 clothes kits through CVA (tentatively 7,300 in north Gaza and 2,000 in South Gaza, contingent on supplier's availability) before 13 July. The main prioritization criteria is targeting newly displaced HHs that fled without assets.
- **BLDA** Completed distributing of clothing vouchers to 1,540 children in Gaza, allowing families to choose items directly from the market.

UPDATES From 04 June SAG

- Finalized and endorsed the SAG position paper on Considering The Use of Rental Assistance as of June 2025.
- This position paper sets out why rental assistance is not considered appropriate at this time, including for very vulnerable cases. This recommendation is applicable for both supporting households to access housing units or land (i.e. tent plots/make-shift shelter plots).
- Note the term 'rental assistance' is used rather than 'cash for rent' or 'rental subsidy' because it highlights all the other components of rental assistance, such as exit strategy support, tenure support, housing living conditions support that 'cash for rent' does not.
- The document is uploaded to the SC website: [Rental Support Position](#)



PALESTINE
SHELTER CLUSTER

Coordinating Humanitarian Shelter and Settlements

WB UPDATE

IDP Assessment – Updates

- By the time of the meeting, 1,800 surveys had been completed, with expectations to reach 2,500 by week's end.
- ACF has committed to supporting data cleaning, validation, and analysis for the representative sample. ACF will provide the cleaned dataset and preliminary findings by 16–17 June (Estimated)
- Discussions raised whether the full caseload should still be pursued. MoSD, UNRWA, and other partners will internally discuss continuing full data collection.
- Focus will be placed on analyzing the representative sample for cluster-wide use.
- The Shelter Cluster will coordinate with the WASH, FSS, and OCHA clusters to enhance information management (IM) capacity and establish a joint reporting framework, while preserving the autonomy of each cluster in conducting its own analysis and reporting.
- Based on data from the IDPs survey the cluster aims to develop context-relevant, feasible temporary shelter options.

Next Steps

- Cluster team to draft Terms of Reference (ToRs) for the Technical Working Group to develop the guidelines for temporary shelter solutions for the IDPs.
- Partners are requested to share their interest and technical contributions.
- Feasibility considerations (market availability, political context) must guide final recommendations.

Cluster Monitoring Tools – Tools & Plans

- Proposal to standardize 4Ws/5Ws reporting in a quarterly Excel format. Recommendations use an offline Excel tool, circulated quarterly by the cluster IM team
- Will help map who is doing what, where, and with which resources.
- Mapping will cover presence, sectors, stockpiles, logistics, and prepositioning.
- Each agency to nominate a focal point to report regularly.

WB Preparedness Plan – Summary Strategy

- A 2–3 page plan will detail emergency readiness measures for shelter/NFI response in west Bank involving key stakeholders and relevant ministries in coordination.
- Plan includes: priority items, specs, quantities, unit cost, and target areas.
- Geographic focus: Area C, and Northern WB.
- Designed for rapid mobilization in case of displacement (Est. 30,000–50,000 people).

Rental Market Survey – Plan & Methodology

- Purpose: inform rental assistance programs for IDPs and host communities.
- Focus: Tulkarem and Jenin governorates.
- 24 key informant interviews planned over 3 weeks.
- Topics include price trends, security of tenure, protection issues, and housing quality.



PALESTINE
SHELTER CLUSTER

Coordinating Humanitarian Shelter and Settlements

IM UPDATE (Gaza)

IM UPDATES (Stock Status)

Available stock of key
shelter items in Gaza
(North and South), as of
[15 May 2025].



PALESTINE
SHELTER CLUSTER
Coordinating Humanitarian Shelter and Settlements

**"Nothing in stock... for
now!"**

IM UPDATES (New IDP 18 Mar–10 June 2025)

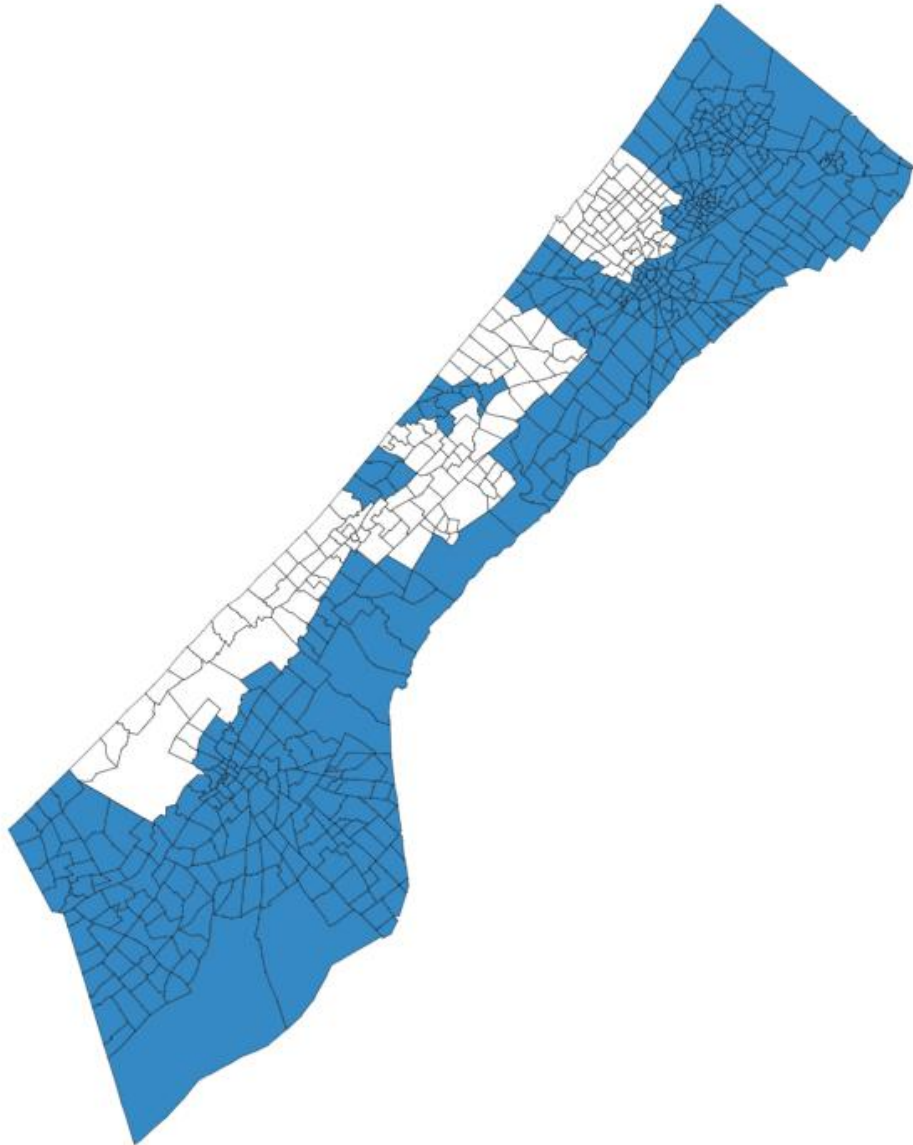

640,273 IDPs

- 33 Evacuation order
- 131 neighborhood affected
- 77 % Of Gaza Strip

IM UPDATES (Gap Analysis Result as of 3rd of June)

Based on the number of people reached over the past six months and the number of people newly displaced during the same period, a thorough analysis—taking all relevant factors into account—indicates that a significant number of people still urgently require shelter assistance.

Emergency Shelter Items



TENT



TARPAULIN



PLASTIC
SHEET

1.3 M



PEOPLE IN
NEED

Household Items



MATTRESS



BLANKET



CLOTHING

1.3 M



PEOPLE IN
NEED



69K

Shelter items in the pipeline



2.9M

NFIs in the pipeline

Border country

All

Type of items

All

Organization

All

Items	Border country	Quantity of items
Clothes	Egypt	20
Multipurpose Tent	Jordan	50
Tents	Israel	360
Kitchen kit	Egypt	900
Emergencny shelter kit	Jordan	1,000
Framing Kits	Jordan	1,300
Tents	Egypt	1,662
ESK	Jordan	2,000
Kitchen kit	Israel	2,000
Sealing Off materials	Israel	2,000
SOK	Egypt	2,000
Tarpaulin	Egypt	2,000
Bedding set	Jordan	2,060
Sealing Off materials	Egypt	4,800
Other	Jordan	10,000
Kitchen sets	Jordan	12,288
Sealing Off materials	Jordan	12,890
Total		3,005,608

Items procured, by border

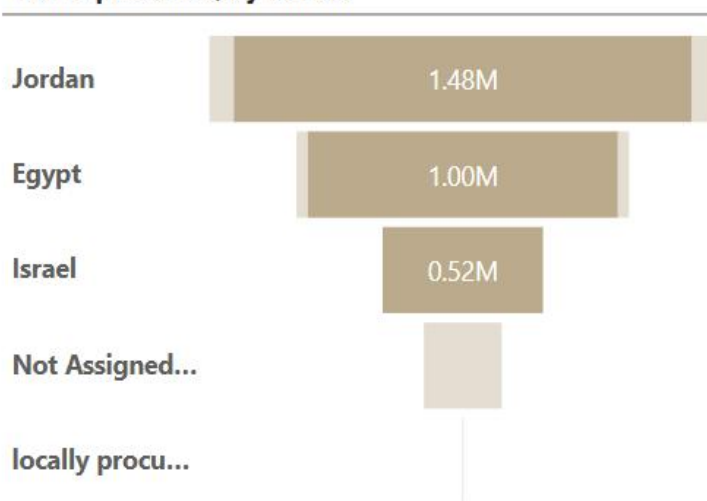

Quantity of items procured, by type

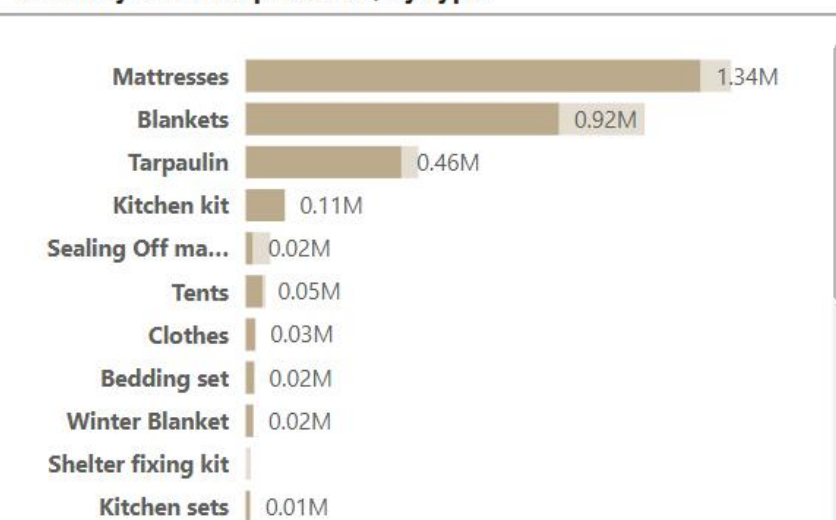

Item procurement status at the border

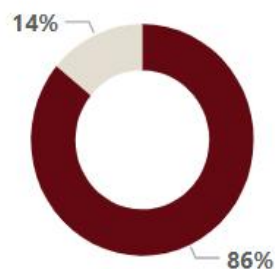

Complete

Ongoing

Procured items by unit type

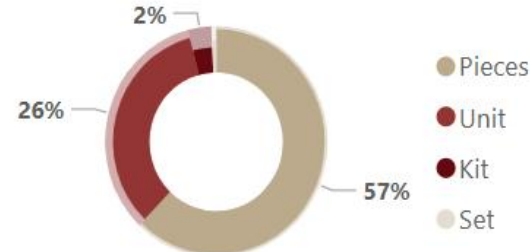

Pieces

Unit

Kit

Set

11

Number of organizations
with items in the pipeline



PALESTINE
SHELTER CLUSTER

Coordinating Humanitarian Shelter and Settlements

Technical Update

Technical Update

- **IEC TWG Update**

IOM supporting on Geodesic Tent IEC

CRS/Oxford Brookes/Care – IEC update and reminder – to follow after this slide

- **Gaza Targeting and Priortisation TWG**

Kick-off meeting has occurred, structure of guidance agreed, and partners are supporting the writing up of different sections.

- **Gaza Local Coping Strategies TWG**

Kick-off meeting has occurred, topics selected:

- (1) Emergency shelter repairs using covering materials, framing materials and debris
- (2) Household led interventions to adapt damaged buildings as living spaces, using alternative construction materials, and salvaged materials
- (3) Adapting to summer heat (summer interventions) and adapting to flood risks
- (4) Undertaking basic livelihood activities with limited household resources, and coping mechanisms for the most vulnerable individuals (such as persons with disabilities) that may relate to privacy or the integration of shelter with water and sanitation facilities (WASH).

Technical Update

IEC what already exists

Ref	Topic	'Phase'	Link
1	Rain and Flooding	Emergency	Protect your shelters from rain and flooding
2	Fire	Emergency	Fire risk mitigation- temporary shelters
3	Tents	Emergency	Tent installation
4	Emergency Shelter Kit	Emergency	Video - How to build an ESK Arabic . Video - How to build an ESK English . IEC – How to build and ESK English Arabic ESK IEC Annexes English Arabic
5	Sealing off kit and return to damaged buildings	Emergency Transitional	Sealing off and safety awareness messages for return to damaged buildings

Emergency Shelter Kit - Gaza

Emergency Shelter Kit (ESK) Overview:

- Intended to go past tents and tarps with the provision of framing materials (timber and fixings), a sealing of kit and some tools.
- More flexible than a tent.
- ESK is an emergency shelter which could be incrementally upgraded.
- During the cease fire understood one partner managed to get 1000 kits in – following up to understand how these were used by households.

Emergency Shelter Kit (ESK) IEC:

- Outlines techniques to assemble a shelter with ESK.
- Focuses on good principles related to timber construction and maximizing the living space with limited materials.
- Partners can adapt the IEC to their specific programming.

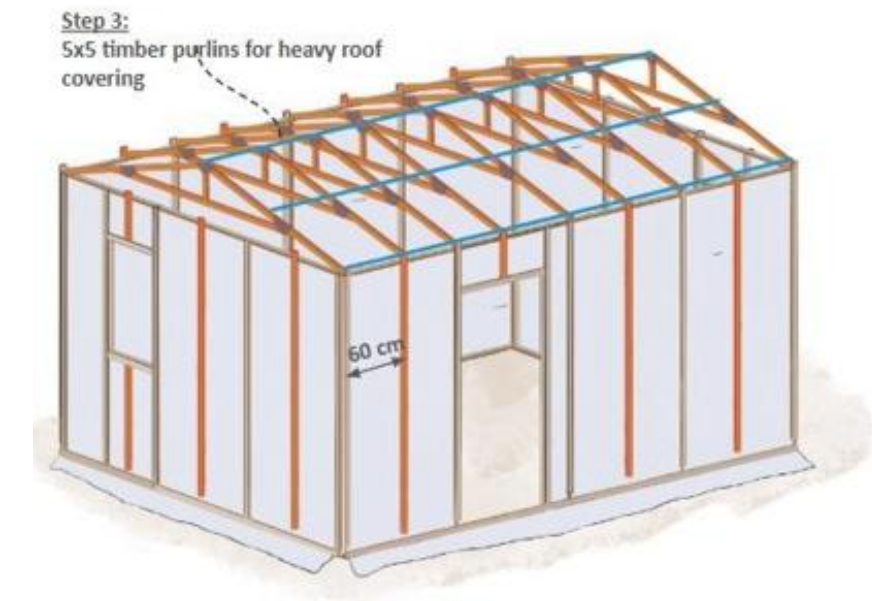

Technical Update

IEC TWG Update – CRS/CARE/Oxford Brookes

Shelter Upgrade and Improvements

As materials become available, the walls can be improved with internal and external cladding.

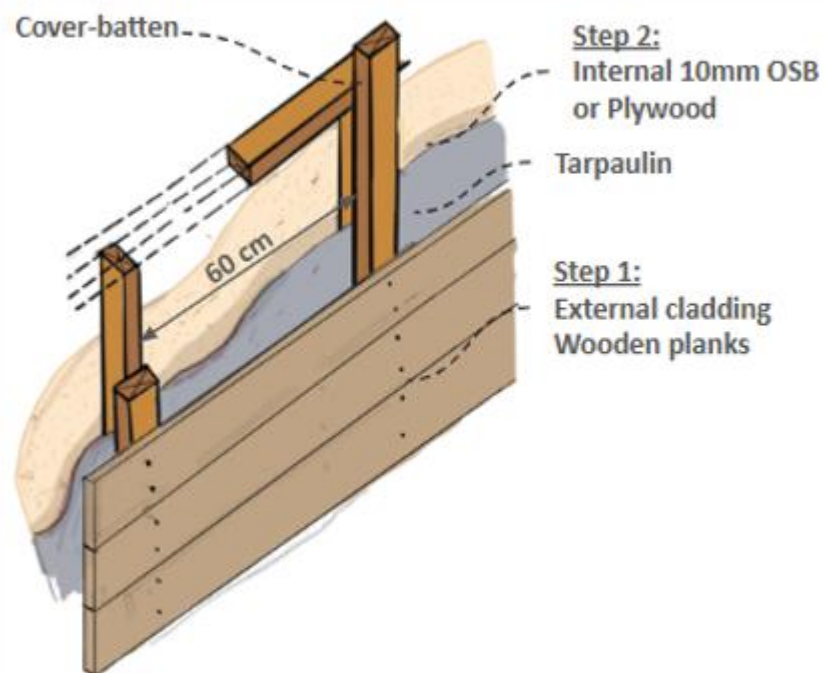

9 or 11mm OSB, or plywood, on the inside and wooden planks on the outside - or any other available materials

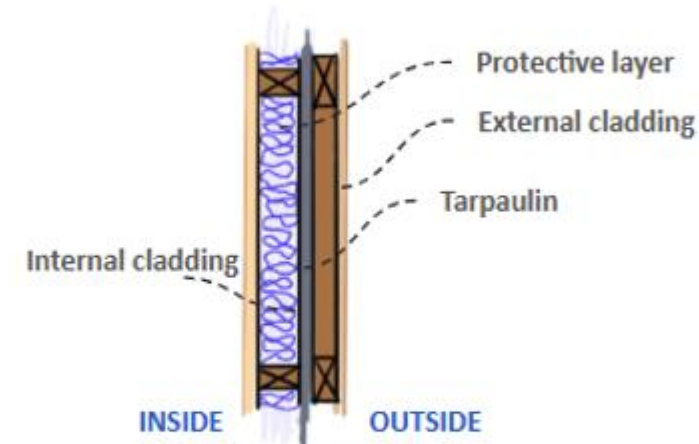

Plastic, cardboard, plastic bottles, or other suitable materials can be placed between the wall layers to create a protective barrier that helps reduce moisture penetration and prevents water-related damage to the timber.

Panel details

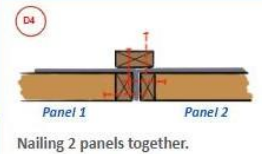
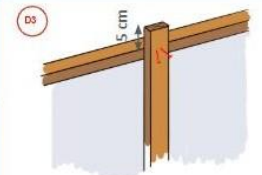
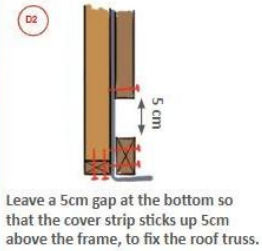
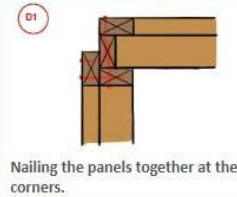
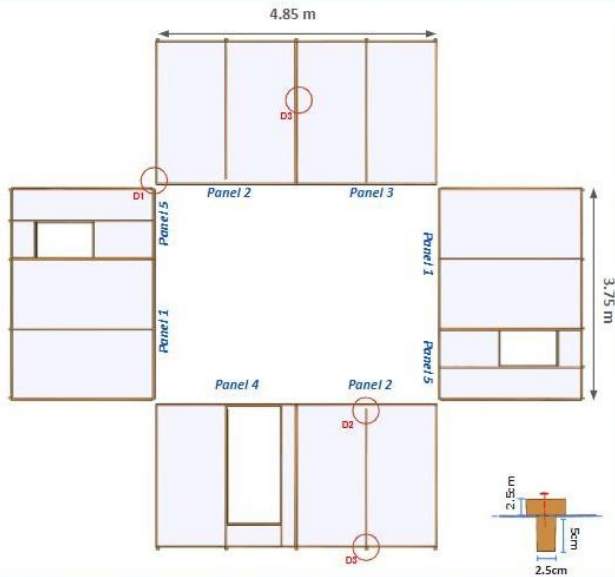

Panel details - Exterior facades, the frame is constructed as T section

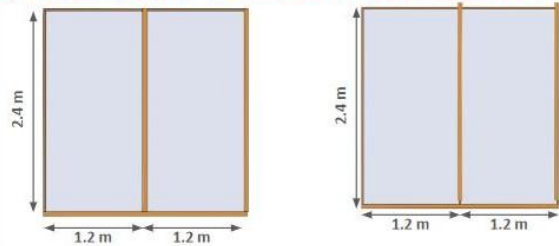

Panel 1: 9 timbers

Panel 2: 9 timbers

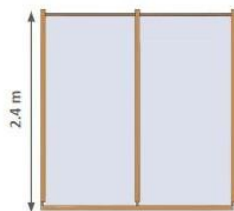

Panel 3: 10 timbers

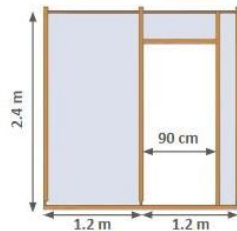

Panel 4 - Door: 10 timbers

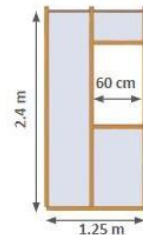

Panel 5 - Window: 12 timbers

Mono-Pitched Roof: Trusses

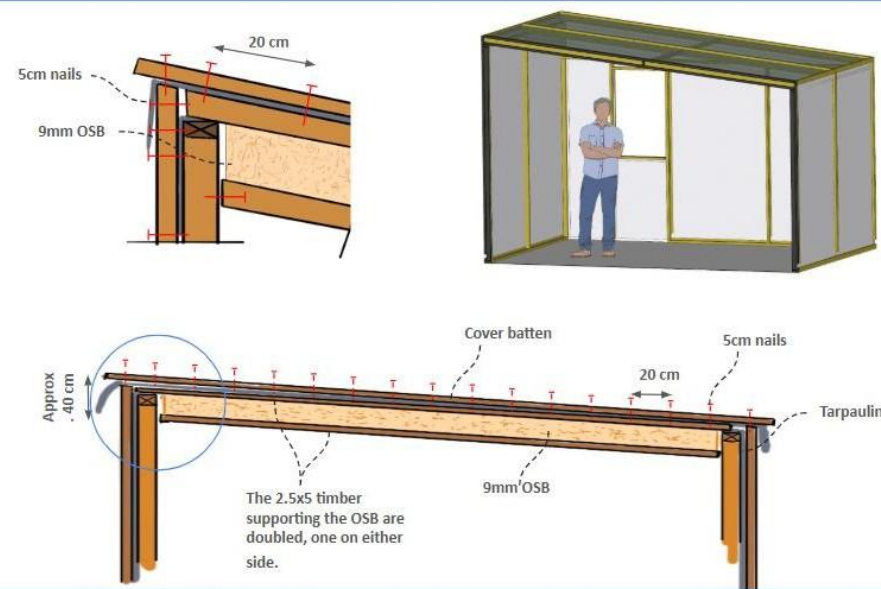

Option 1: 9 or 11mm OSB, or plywood,

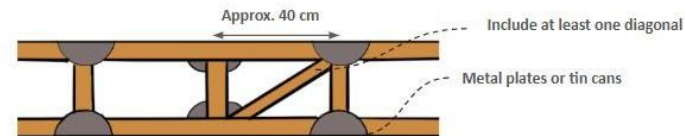

Option 2: Metal plates or tin cans

Beams

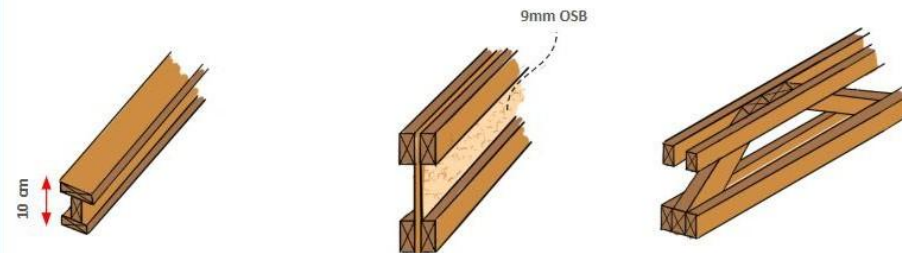

With timber only

Fix 9mm OSB between 4 horizontal timbers

Fix an "open web" timber beam between 4 horizontal timbers

Shelter Upgrade and Improvements

As materials become available, the walls can be improved with internal and external cladding.

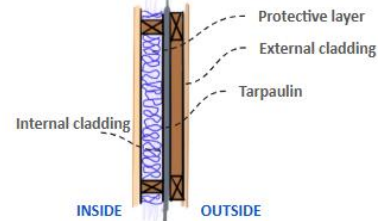
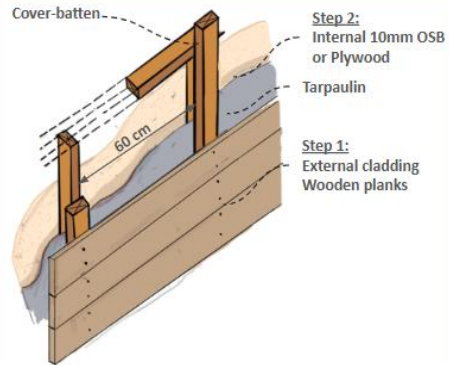

Plastic, cardboard, plastic bottles, or other suitable materials can be placed between the wall layers to create a protective barrier that helps reduce moisture penetration and prevents water-related damage to the timber.

9 or 11mm OSB, or plywood, on the inside and wooden planks on the outside - or any other available materials

Step 3:
5x5 timber purlins for heavy roof covering



Put in more vertical studs (studs plus cover-battens) so that the spacing is 60cm and not 120cm. The trusses could be at 60cm spacing too and this would help to strengthen the roof for heavier roof covering.

The roof can also be upgraded, but only with light weight material. For any heavier material, including Corrugated Steel (CGI), the trusses or beams would need to be stronger to support extra weight.

Safety: Fire and Extreme Heat

Presentation by Rana Ayoub of CRS

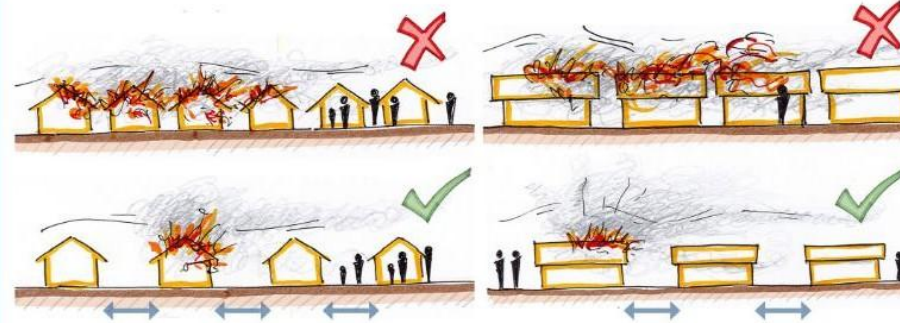

Reference: Shelter Cluster website, Basic Guidance on Shelter Upgrading, Cox's Bazar Crisis

Keep a distance of at least 2 to 3m between buildings to reduce the risk of fire spreading.



Make window openings at least 45 cm wide and 75 cm in height for escape in the case of fire.

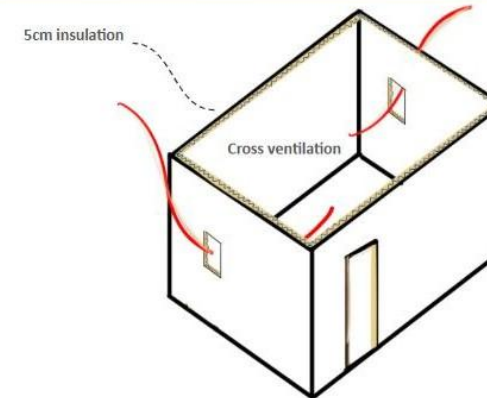

Adding a minimum of 5cm of insulation to the walls and roof will also reduce the risk of very high temperatures in summer.

HELPFUL TIP

To ensure good cross-ventilation, windows should be at least 40x40 cm on opposite sides.

5x5 Timber: Good Practice

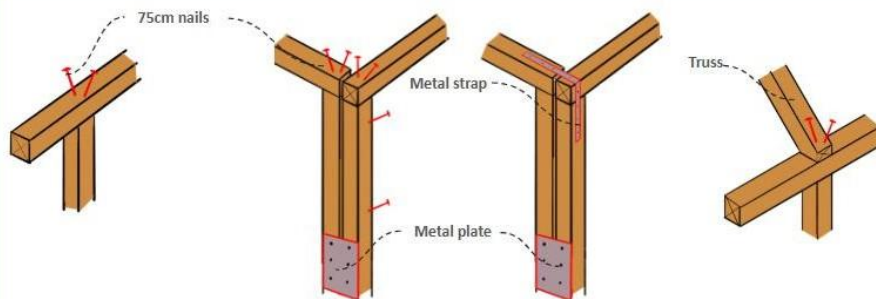

"Skew nailing" hammer in the nails at a slight angle

Fix the corners securely. Metal plates from used tin cans can be used.

Connect the trusses or beams securely.

5X5 timber schematic layout showing alternative bracing

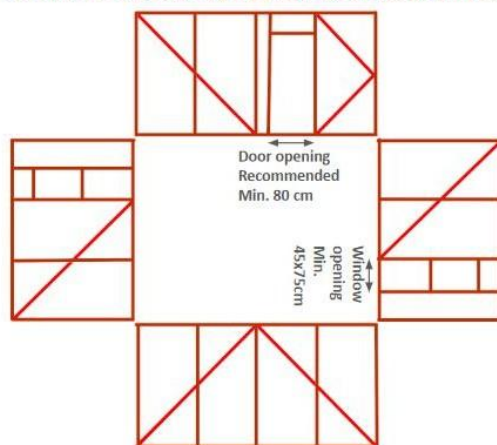

5x5 timber structures must be braced on **all four walls, the corners, and the roof trusses**

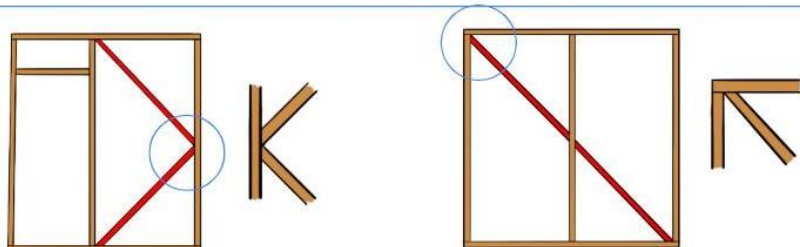

K-bracing used for door panel. The point of the K bracing must be into a corner.

Node to node for other panels

5x5 Timber: Good Practice

WEAKER
STRONGER

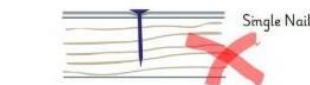

Standard nails will easily pull through plastic sheeting as they have small heads



Standards nails can be improved by bending them or nailing them through folded plastic sheet or rope. U-shaped fencing pins can also be used.

Spread the Load

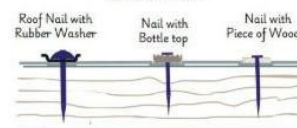

Standards nails can be improved using washers or bottle caps (sharp side away from plastic) to spread the load. Alternatively domed head nails can be used.

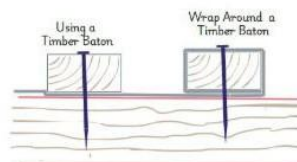

Using timber battening is very good for spreading the load.

Plastic sheeting should be folded over on itself at connection points.

Plastic sheeting is best fixed so as to spread the load along the (smoothed) edge of the supporting structure.

Reference:

1. Shelter Cluster website, Hurricane Beryl 2024 - Regional Response, Fixing tarpaulin
2. OXFAM Technical Brief – Plastic sheeting use and procurement in humanitarian relief

HELPFUL TIP

Once good-quality plastic sheeting is procured, it's essential to fix it in a way that spreads the load, prevents flapping, avoids friction points, and limits heat buildup. To avoid tearing, fixings should be distributed over a wide area.



PALESTINE
SHELTER CLUSTER

Coordinating Humanitarian Shelter and Settlements

Discussion / Q&A / AOB

-
- **National SAG: 12h June**
 - Palestine Shelter Cluster Strategy
 - Terms of Reference for the Strategic Advisory Group Palestine
 - Palestine Shelter Cluster Membership Guidelines
 - Write up of co-chairing process to be shared for endorsement
 - **Upcoming meetings:**
 - Gaza Shelter Cluster meeting: 10:30 AM, 15th June
 - Gaza SAG meeting: 2PM, 19th June
 - WB Shelter Cluster meeting: 10AM, 18th June
 - WB SAG meeting: 10AM, 3rd June
 - **Next National Shelter Cluster meeting: 25th June**
 - Partner presentation?